



Rendering courtesy of Presentation Art Studio

City of Longview Roy Morse Park

Longview, WA

This 60-acre park in Longview is currently home to ballfields, a 9-hole disc golf course, and other recreation activities. While it is a well-used park, the facilities are aging, no longer attract regional tournaments, and aren't flexible enough to respond to changing community interests and needs. This master plan defines the community's long-term vision, and illustrates the park's transformation into an exciting athletic facility complex and multi-use park. Through a community-based design process, it became clear that planning for a variety of active and passive park amenities were a priority to the community. This led to a multi-use design approach to the fields and other park spaces. A focus of the master plan is creating an athletic complex which will facilitate league games and regional athletic tournaments, and be an economic driver for the community. The variety of athletic facilities shown are designed for all age groups and should be developed not only for large regional tournaments but also for use by local community groups, schools, and athletic leagues.



HBB Landscape Architecture
Skillings, Inc.
D.A. Hogan & Associates, Inc.
BERK Consulting, Inc.



Rendering courtesy of Presentation Art Studio

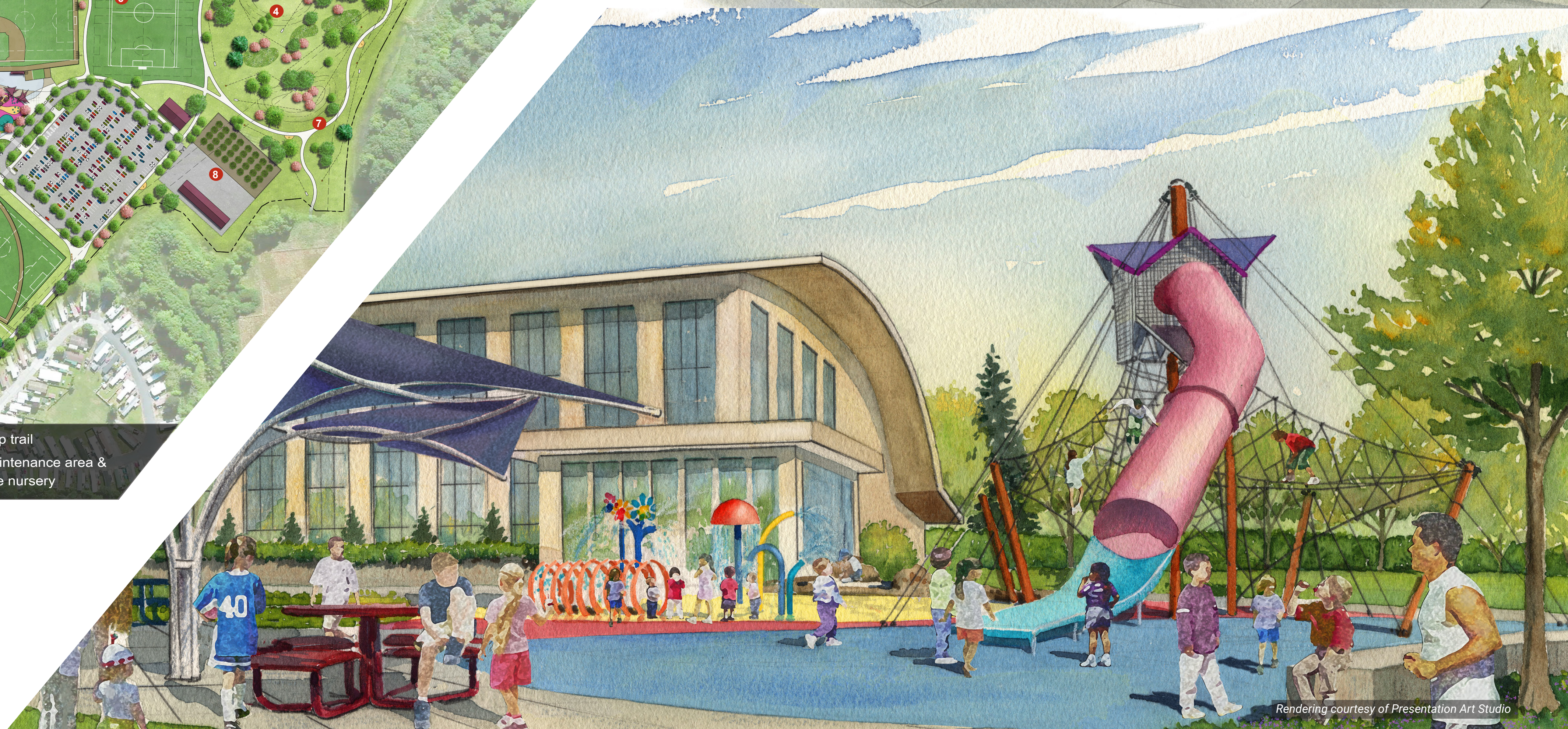

Rendering courtesy of Presentation Art Studio